

THIS INFORMATION IS CONFIDENTIAL AND IS DISCLOSED TO YOU ON CONDITION THAT NO FURTHER DISCLOSURE IS MADE BY YOU TO OTHER THAN PEXON PERSONNEL WITHOUT WRITTEN AUTHORIZATION FROM PEXON LTD.

DWG NO.
C-100158

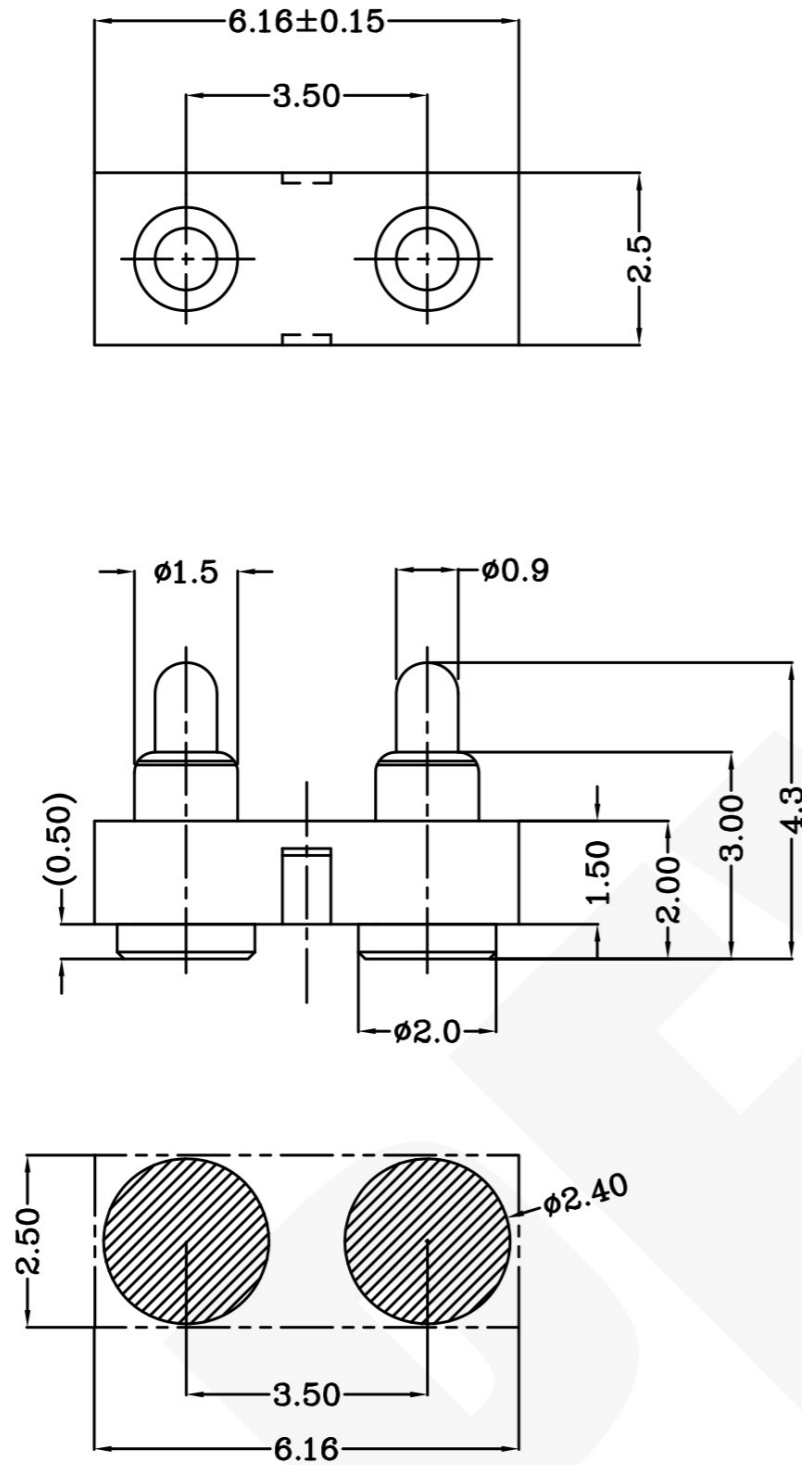

USED ON
-



Recommended PCB Layout

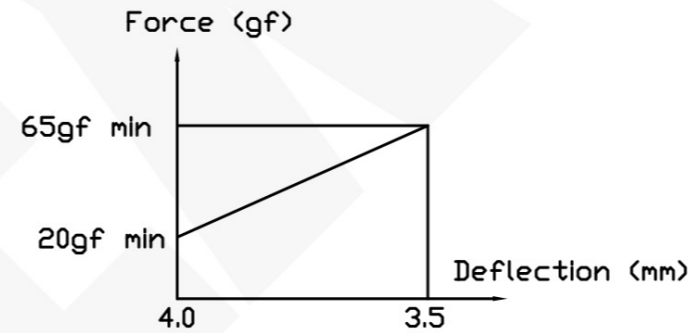

- Notes:
- Material, Housing: PA 4.6 (30% Glass Filled)
Color Black.
Contact: Brass
 - Mechanical demands:
Plating Plunger: 0.4um Au over 1.4um Ni
Plating Body: 0.1um Au over 1.4um Ni.

LOC -
DIST -

| LTR | REVISION RECORD | APVD | DATE |
|-----|-----------------|------|------------|
| | update remark | | 2007/09/07 |

DIMENSIONS IN MM
TOLERANCES UNLESS
OTHER SPECIFIED
0 = ±-
0.0 = ±0.15
0.00 = ±0.10
0.000 = ±
ANGLE: ±1°
SURF TEXTURE: 3.2/
REMOVE BURRS. BREAK
SHARP EDGES R0.05 MAX
DO NOT SCALE PRINT

| | | | | | |
|---|-------|-------|------------------|--------------|-------|
| MATL | 1 | HT TR | - | FIN | - ✓ |
| DWN | Benny | APVD | | Pexon | |
| CHK | | REL | | | |
| NAME BATTERY POGO CONNECTOR 2 POSITIONS PGC-1.5-4.3-R-2P-3.5PH | | | | | |
| SCALE | 1:1 | A4 | DWG NO. C-100158 | SHEET 1 OF 1 | REV B |

4

3

2

1

D

C

B

A



PEXON

E-mail: sale@pinconnector.com

WhatsApp: +86-13361867201

www.pinconnector.com