

THIS INFORMATION IS CONFIDENTIAL AND IS DISCLOSED TO YOU ON CONDITION THAT NO FURTHER DISCLOSURE IS MADE BY YOU TO OTHER THAN PEXON PERSONNEL WITHOUT WRITTEN AUTHORIZATION FROM PEXON LTD.

DWG NO.  
C-100219

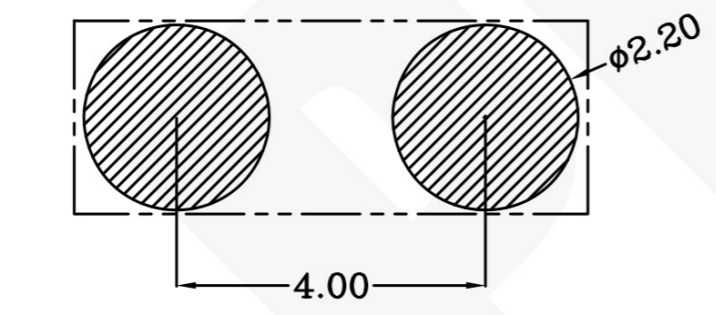

USED ON  
-

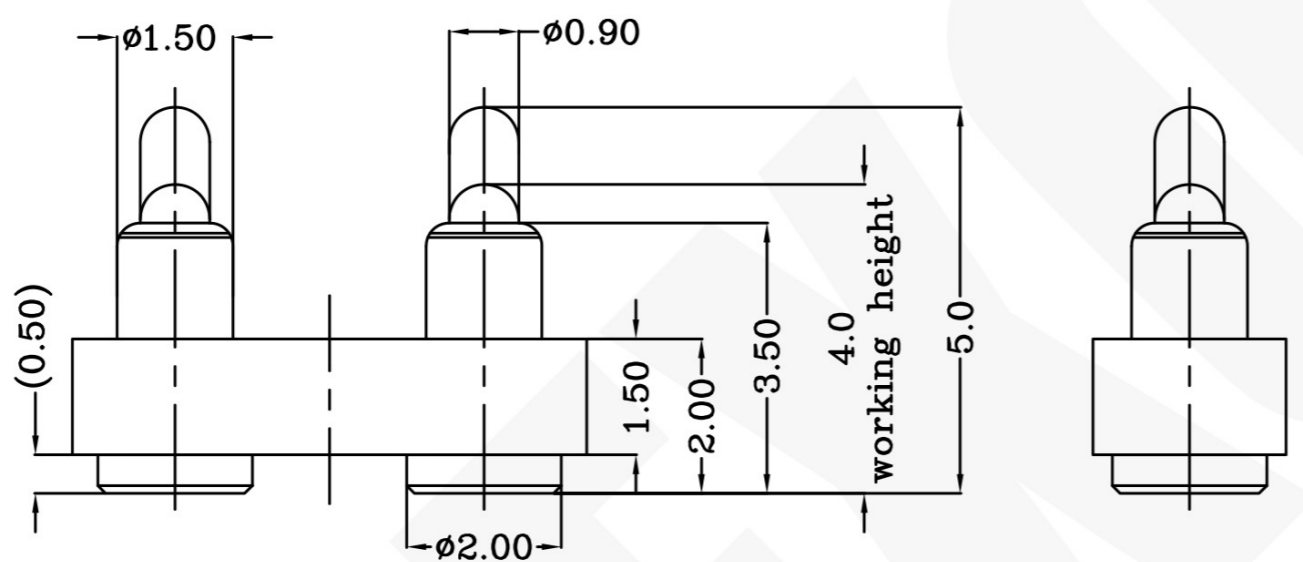
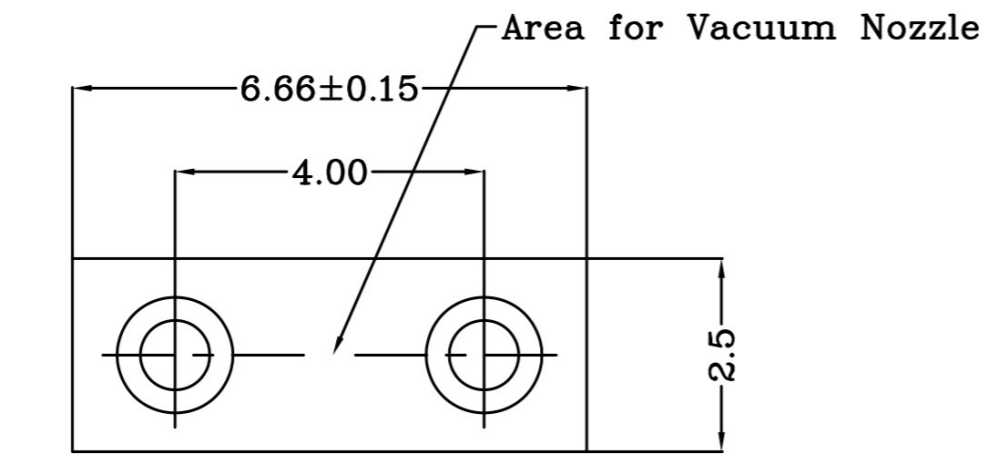

Recommended solder patse thickness is 0.10 mm  
Recommended PCB Layout

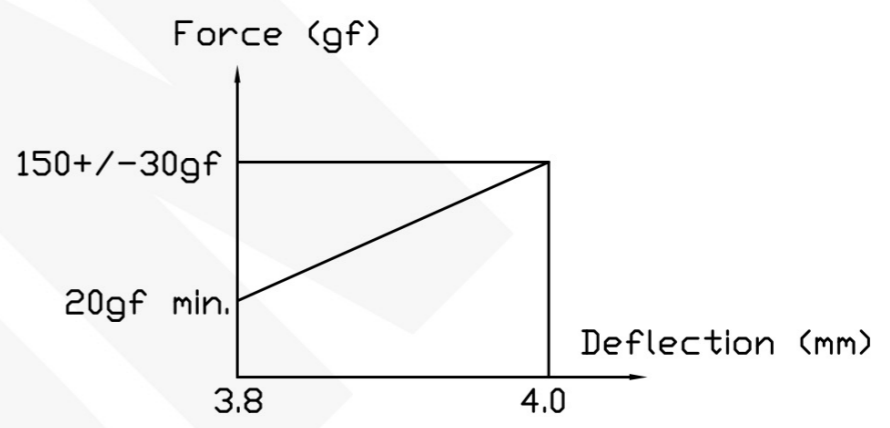

- Notes:
- Material, Housing: PA 4.6 (30% Glass Filled)  
Color Black.  
Contact: Brass
  - Mechanical demands:  
Plating Plunger: 0.4um Au over 1.4um Ni  
Plating Body: 0.1um Au over 1.4um Ni.

LDC	-
DIST	-

update remark	2007/12/26
LTR	REVISION RECORD
APVD	DATE

DIMENSIONS IN MM  
TOLERANCES UNLESS  
OTHER SPECIFIED  
0 = ±-  
0.0 = ±0.15  
0.00 = ±0.10  
0.000 = ±  
ANGLE: ±1°  
SURF TEXTURE: 3.2/  
REMOVE BURRS. BREAK  
SHARP EDGES R0.05 MAX  
DO NOT SCALE PRINT

MATL	HT TR	FIN
1	-	✓
DWN Benny	APVD Lansing	<b>PEXON</b>
CHK Andy	REL	
NAME BATTERY POGO CONNECTOR 2 POSITIONS PGC-1.5-5.0-R-2P-4.0PH		
SCALE 1:1	A4	DWG NO. C-100219
SHEET 1 OF 1		REV C

100219-2
PART NUMBER



**PEXON**

E-mail: [sale@pinconnector.com](mailto:sale@pinconnector.com)

WhatsApp: +86-13361867201

[www.pinconnector.com](http://www.pinconnector.com)