

THIS INFORMATION IS CONFIDENTIAL AND IS DISCLOSED TO YOU ON CONDITION THAT NO FURTHER DISCLOSURE IS MADE BY YOU TO OTHER THAN PEXON PERSONNEL WITHOUT WRITTEN AUTHORIZATION FROM PEXON LTD.

DWG NO.
C-100172

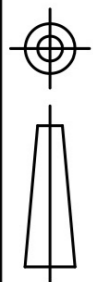

USED ON
-

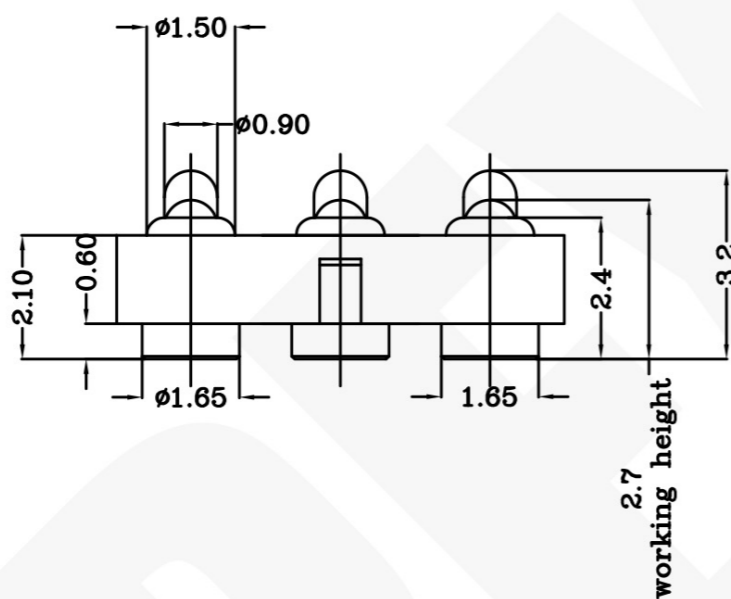
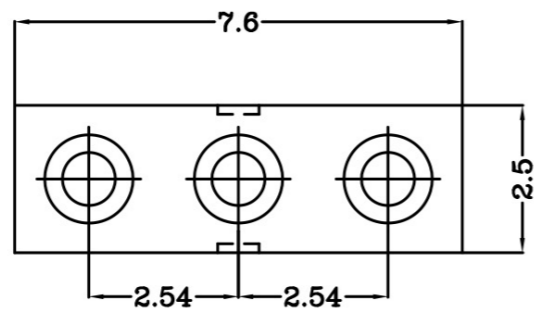

- Notes:
 1 Material, Housing: PA 4.6 (30% Glass Filled)
 Color Black.
 Contact: Brass
 2 Mechanical demands:
 Plating Plunger: 0.4Um Au over 1.25um Ni
 Plating Body: 0.1Um Au over 1.25um Ni.

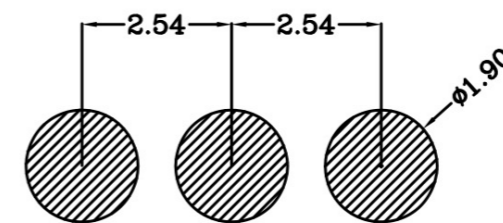
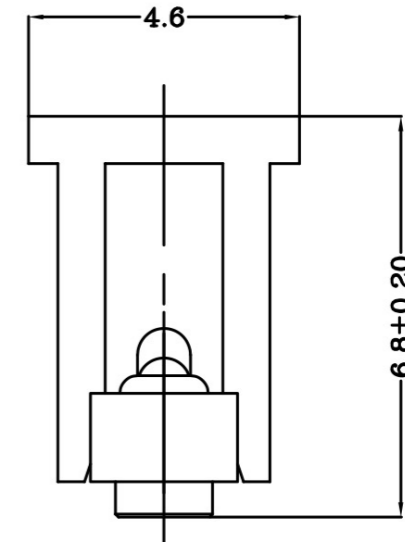
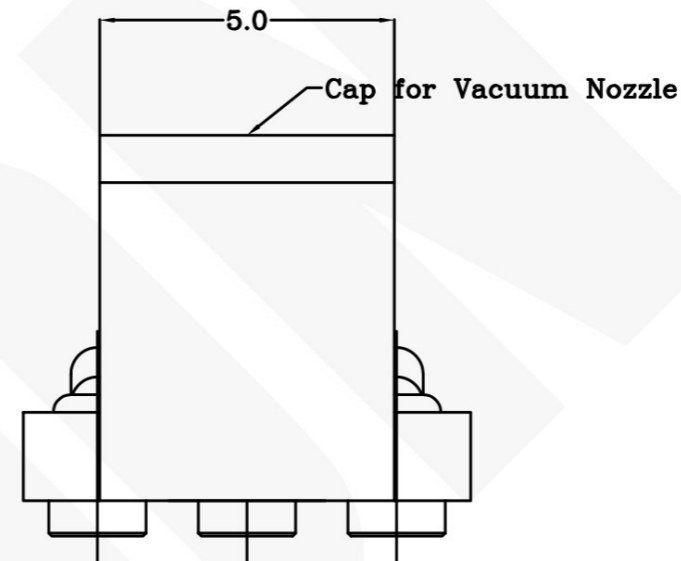

Recommended Solder Paste thickness is 0.10 mm

Recommended PCB Layout

100172-3

PART NUMBER

DIMENSIONS IN MM TOLERANCES UNLESS OTHER SPECIFIED		MATL	△ 1	HT TR	-	FIN	- ✓
0	= ±	DWN		APVD	Lansing	Pexon	
0.0	= ±0.15	QIn		CHK	REL		
0.00	= ±0.10	CHK	JIm	NAME			BATTERY POGO CONNECTOR 3 POSITIONS
0.000	= ±				PGC-1.5-3.2-R-3P-2.54PH		
ANGLE: ±1°		SCALE	1:1	A4	DWG NO.	C-100172	SHEET 1 OF 1
SURF TEXTURE: 3.2/√							REV B
REMOVE BURRS. BREAK SHARP EDGES R0.05 MAX DO NOT SCALE PRINT							

LOC	-
DIST	-

	update remark		2008/01/14
LTR	REVISION RECORD	APVD	DATE

4

3

2

1

D

C

B

A



PEXON

E-mail: sale@pinconnector.com

WhatsApp: +86-13361867201

www.pinconnector.com